



15" W. CRAFT ICE MACHINE

FCIU

PROFESSIONAL FEATURES

- Industry-exclusive slow melting clear ice cubes perfect for whiskeys and cocktails
- Produces square cubes 1-7/8" L x 1-7/8" W x 1-1/4" H
- High production rate of 160 cubes per day
- Up to 25 lbs in ice storage capacity
- Industry leading BrightShield® antimicrobial lighting creates a clean environment for ice
- Designed for built-in or freestanding applications
- Easy clean process only lasts 45 minutes
- Factory installed drain pump included
- High efficiency variable speed compressor with 1.7 running amps
- Ice scoop included
- Indicator alert notifies when cleaning is needed
- Silent setting temporarily suspends ice making for 3 hrs
- Soft-close articulating door hinge with reversible door
- Accepts 3/4" or 5/8" custom panels or accessory door panel kits

MODEL NUMBER

- FCIU515D – 15" Craft Ice Machine with Pump, Solid Panel Ready



FCIU515D
(shown with custom panel)

ACCESSORIES

- PDPUS515SS – Professional Door Panel, Stainless Steel
- CDPUS515SS – Classic Door Panel, Stainless Steel

DESIGN OPTIONS

- Field reversible soft-close door allows for right or left swing
- Choice of two accessory door panel kits for each unit
 - Professional Door Panel features the iconic Viking handle for true design integrity
 - Classic Door Panel features a slim handle that coordinates with any kitchen design

WARRANTY

- 2-year full covers complete unit
- 6-year full – sealed refrigeration system
- 90-day full – cosmetic parts such as glass, painted items, and decorative items
- 12-year limited – sealed refrigeration system



15" W. CRAFT ICE MACHINE

FCIU

FRONT

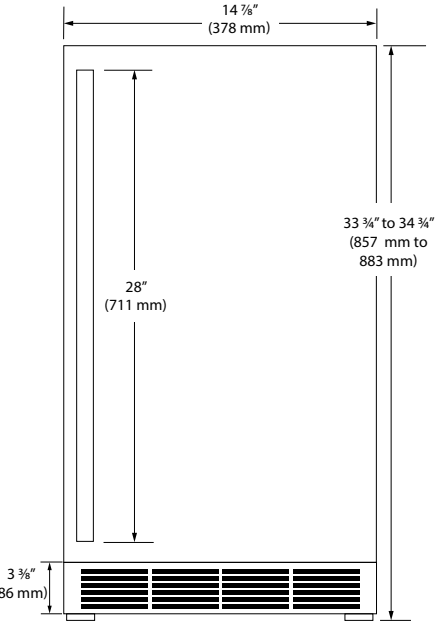

SIDE

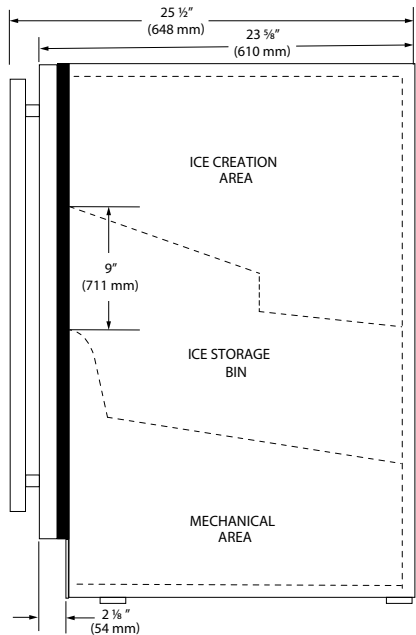

TOP

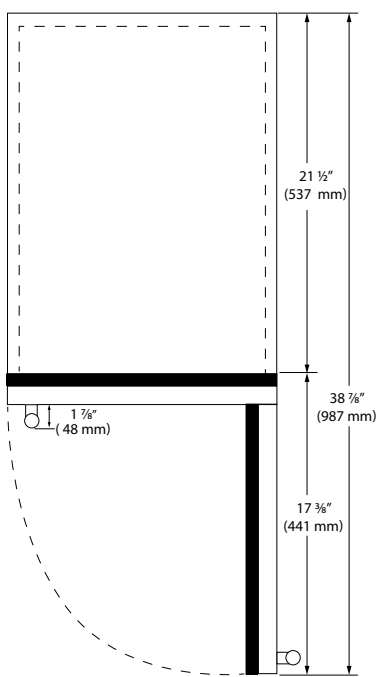

15" W. CRAFT ICE MACHINE	
DESCRIPTION	FCIU515D
Overall Width	14-3/4" (375 mm)
Overall Height	33-3/4" to 34-3/4" (857 mm to 883 mm)
Overall Depth from Rear	To front of door: 23-5/8" (600 mm) To handle: 25-1/2" (648 mm) With door at 90° angle: 38-7/8" (987 mm)
Electrical Requirements	115V/60Hz/15A
Amps: Running	1.7 amps
Maximum Storage Capacity	25 lbs.
Cord Length	6 ft.
Interior Finish	Black
ENERGY STAR	No
Refrigerant Type	R600a
Sabbath Mode	Yes
Shipping Dimensions	18"W. x. 29"D. x 36"H.
Approximate Shipping Weight	122 lbs. (55.3 kg)

Please do not prepare installation from brochure data only. See installation instructions for important clearance/installation information.

BACK

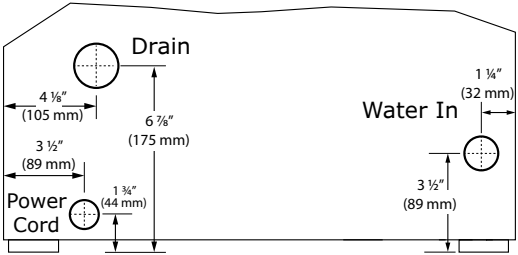

CABINET CUT-OUT

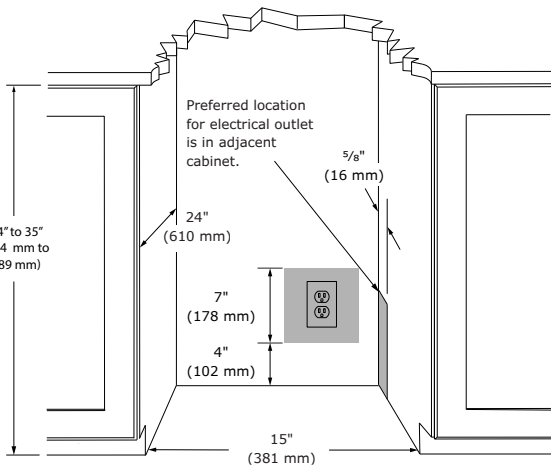

VIKING RANGE, LLC 111 FRONT STREET GREENWOOD, MISSISSIPPI 38930 USA

For detailed product information, model numbers, or to request a quote call 1-888-845-4641 or visit vikingrange.com
© 2025 Viking Range, LLC All rights reserved. Specifications subject to change without notice.