

FOR SERVICE TECHNICIAN'S USE ONLY

Do not discard

⚠ DANGER

Electrical Shock Hazard

Only authorized technicians should perform diagnostic voltage measurements.

After performing voltage measurements, disconnect power before servicing.

Failure to follow these instructions can result in death or electrical shock.

⚠ WARNING

Electrical Shock Hazard

Disconnect power before servicing.

Replace all parts and panels before operating.

Failure to do so can result in death or electrical shock.

Voltage Measurement Safety Information

When performing live voltage measurements, you must do the following:

- Verify the controls are in the off position so that the appliance does not start when energized.
- Allow enough space to perform the voltage measurements without obstructions.
- Keep other people a safe distance away from the appliance to prevent potential injury.
- Always use the proper testing equipment.
- After voltage measurements, always disconnect power before servicing.

PRECAUTIONS TO BE OBSERVED BEFORE AND DURING SERVICING TO AVOID POSSIBLE EXPOSURE TO EXCESSIVE MICROWAVE ENERGY

- a. Do not operate or allow the oven to be operated with the door open.
- b. Make the following safety checks on all ovens to be serviced before activating the magnetron or other microwave source, and make repairs as necessary:
 1. Interlock Operation
 2. Proper Door Closing
 3. Seal and Sealing Surfaces (Arcing, Wear and Other Damage)
 4. Damage to or Loosening of Hinges and Latches
 5. Evidence of Dropping or Abuse
- c. Before turning on microwave power for any service test or inspection within the microwave generating compartments, check the magnetron, wave guide or transmission line, and cavity for proper alignment, integrity and connections.
- d. Any defective or misadjusted components in the interlock, monitor, door seal, and microwave generation and transmission systems shall be repaired, replaced, or adjusted by procedures described in this manual before the oven is released to the owner.
- e. A microwave leakage check to verify compliance with the Federal Performance Standard should be performed on each oven prior to release to the owner.
- f. Do not attempt to operate the oven if the door glass is broken.

IMPORTANT SAFETY NOTICE – “For Technicians only”

This service data sheet is intended for use by persons having electrical, electronic, and mechanical experience and knowledge at a level generally considered acceptable in the appliance repair trade. Any attempt to repair a major appliance may result in personal injury and property damage. The manufacturer or seller cannot be responsible, nor assume any liability for injury or damage of any kind arising from the use of this data sheet.



FOR SERVICE TECHNICIAN'S USE ONLY

FAILURE CODE INDICATIONS			
Display	Likely Failure Condition	Recommended Repair Procedure	
NOTE: Many of the problems listed in the chart below may be solved by power cycling: Unplug microwave oven or disconnect power. After 1 minute, plug in microwave oven or reconnect power.			
Enter the Diagnostics mode (press CANCEL - CANCEL - START) and press TIME/POWER to verify the failure code. If the failure code displayed matches complaint, see chart below for details.			
F1E4	Microwave ACU failure	<ol style="list-style-type: none"> 1. Unplug microwave oven or disconnect power. 2. Replace ACU. 	<ol style="list-style-type: none"> 3. Replace all parts and panels before operating. 4. Plug in microwave oven or reconnect power.
F2E1	Stuck key failure	<ol style="list-style-type: none"> 1. Unplug microwave oven or disconnect power. 2. Replace touch panel. 	<ol style="list-style-type: none"> 3. Replace all parts and panels before operating. 4. Plug in microwave oven or reconnect power.
F4E1	Cavity temperature sensor failure	<ol style="list-style-type: none"> 1. Enter the Diagnostics mode (press CANCEL - CANCEL - START), and then press Convect Bake or Bake to display the cavity temperature sensor reading. Verify the sensor temperature reading is at room temperature (typically 50°F to 90°F [10°C to 32°C]) and verify failure code. If failure code matches complaint, continue to Step 2. 2. Unplug microwave oven or disconnect power. 3. Disconnect sensor from ACU. 4. Measure sensor resistance between connector pins and confirm reading is between 9.7 kΩ and 10.3 kΩ at room temperature. If measurement is not correct, or if a short or open circuit is found, replace sensor. 	<ol style="list-style-type: none"> 5. Replace all parts and panels before operating. 6. Plug in microwave oven or reconnect power. 7. Enter the Diagnostics mode (press CANCEL - CANCEL - START), and then press Convect Bake or Bake to display the cavity temperature sensor reading. Verify the sensor temperature reading. If the reading is correct, stop. 8. If the reading is still not correct, unplug microwave oven or disconnect power. 9. Replace ACU. 10. Replace all parts and panels before operating. 11. Plug in microwave oven or reconnect power.
F4E4	Humidity sensor error	<ol style="list-style-type: none"> 1. Enter the Diagnostics mode (press CANCEL - CANCEL - START), and then press Cook/Reheat to display the humidity sensor reading. If display does not show “8891,” continue to Step 2. 2. Unplug microwave oven or disconnect power. 3. Connect a new humidity sensor to the ACU P6 connector. 4. Replace all parts and panels before operating. 5. Plug in microwave oven or reconnect power. 	<ol style="list-style-type: none"> 6. Enter the Diagnostics mode (press CANCEL - CANCEL - START), and then press Cook/Reheat to see if failure code reappears. NOTE: There may be a delay (approximately 1 minute, 20 seconds) before the failure code is displayed. 7. If the failure code reappears, unplug microwave oven or disconnect power. 8. Replace ACU. 9. Replace all parts and panels before operating. 10. Plug in microwave oven or reconnect power.
F4E9	Popcorn error	<ol style="list-style-type: none"> 1. Enter the Diagnostics mode (press CANCEL - CANCEL - START), and then press POPCORN or ACCUPOP. 2. Knock on the microwave oven door no fewer than 12 times within 5 seconds to check if the counter display operates properly. 3. If the counter does not operate properly, unplug microwave oven or disconnect power. 4. Check to see if the sound channel is blocked or the tube is loosened. 5. If the sound channel and tube are not blocked, connect a new Popcorn cable to the ACU. 6. Replace all parts and panels before operating. 	<ol style="list-style-type: none"> 7. Plug in microwave oven or reconnect power. 8. If failure code reappears, unplug microwave oven or disconnect power. 9. Replace Popcorn ACU. 10. Replace all parts and panels before operating. 11. Plug in microwave oven or reconnect power. 12. If failure code reappears, unplug microwave oven or disconnect power. 13. Replace ACU. 14. Replace all parts and panels before operating. 15. Plug in microwave oven or reconnect power.
F8E5	Exhaust air template detector failure	<ol style="list-style-type: none"> 1. Enter the Diagnostics mode (press CANCEL - CANCEL - START), and then press Keep Warm to display the HF NTC thermistor reading. Verify the temperature reading is at room temperature (typically 50°F to 90°F [10°C to 32°C]) and verify failure code. If failure code matches complaint, continue to Step 2. 2. Unplug microwave oven or disconnect power. 3. Disconnect HF NTC thermistor cable from ACU. 4. Measure resistance between connector pins and confirm reading is between 9.5 kΩ and 10.5 kΩ at room temperature. If measurement is not correct or a short or open circuit is found, replace HF NTC thermistor. 	<ol style="list-style-type: none"> 5. Replace all parts and panels before operating. 6. Plug in microwave oven or reconnect power. 7. Enter the Diagnostics mode (press CANCEL - CANCEL - START), and then press Keep Warm to display the HF NTC thermistor reading. Verify the temperature reading. If it is still not correct, replace ACU. 8. If failure does not appear, stop.

FOR SERVICE TECHNICIAN'S USE ONLY

PRIMARY, MONITOR, SECONDARY, AND DOOR INTERLOCK SWITCH CHECKOUT PROCEDURES

IMPORTANT: Before checking the interlock switches, unplug microwave oven or disconnect power. Be sure to disconnect all of the wires at the switch being tested before making any continuity readings.

NOTE: The Primary Interlock Switch, Monitor Interlock Switch, and Door Interlock Switch are mounted in door lock switch cradle. All the interlock switches can be identified by the wire colors that are connected to the terminals of the switches. See the chart below for wire color designation.

Switch	Check By	Door Open	Door Closed
Primary Interlock	<ol style="list-style-type: none"> 1. Unplug microwave oven or disconnect power. 2. Disconnect the wires at the Primary Interlock Switch. 3. Check from the common terminal (black/brown wires) to the normally open terminal (black/white wires). 4. Reconnect wires to switch. 	-	+
Monitor Interlock	<ol style="list-style-type: none"> 1. Unplug microwave oven or disconnect power. 2. Disconnect the wires at the Monitor Interlock Switch. 3. Check from the common terminal (white/brown wires) to the normally closed terminal (blue/white wires). 4. Reconnect wires to switch. 	+	-
Secondary Interlock	<ol style="list-style-type: none"> 1. Unplug microwave oven or disconnect power. 2. Disconnect the wires at the Secondary Interlock Switch. 3. Check from the common terminal (white/blue wires) to the normally open terminal (blue/blue wires). 4. Reconnect wires to switch. 	-	+
Door Interlock	<ol style="list-style-type: none"> 1. Unplug microwave oven or disconnect power. 2. Disconnect the wires at the Door Interlock Switch. 3. Check from the common terminal (blue wire) to the normally closed terminal (orange wire). 4. Reconnect wires to switch. 	+	-

(+) Continuity (-) No Continuity

NOTE: These diagrams are not intended to show a complete circuit; they represent the position of switches during “DOOR OPEN” or “DOOR CLOSED” (continuity checks only)

NOTE: Interlock, Monitor switches and Door interlock switch cannot be adjusted and all these switches should be replaced if any one of them is found to be defective. After replacing interlock/monitor switches, reconnect wires to switch and check for continuity. Safety interlocks and monitor switches will actuate within 2 mm.

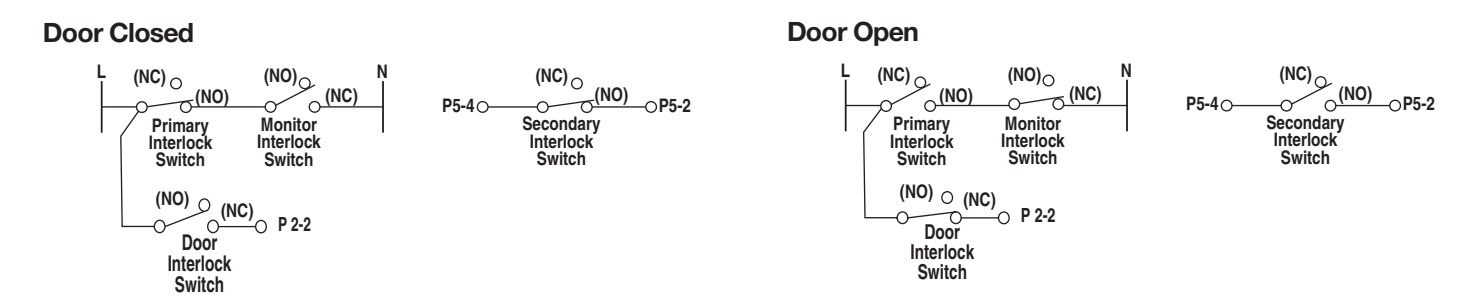

NOT HEATING TROUBLESHOOTING INSTRUCTION

IMPORTANT: High voltage is present at the magnetron and high-voltage capacitor terminals. Avoid direct contact when power is connected to these components to avoid serious injury or possible death. Always be sure that the high-voltage capacitor is discharged before accessing any of these components.

For a no-heat condition, refer to the following step-by-step instructions:

1. Unplug microwave oven or disconnect power.
2. Discharge the high-voltage capacitor.
3. Disconnect the high-voltage transformer primary windings.
4. Attach the voltmeter leads to the high-voltage transformer primary input wires.
5. Plug in microwave oven or reconnect power.
6. Close door and program the microwave oven to operate for 30 seconds.
7. Press START.
8. Check the input voltage at the high-voltage transformer primary input wires. If the voltage is not close to the rating voltage 120 +/-15 VAC, unplug microwave oven or disconnect power. Check the circuitry as follows:
 - Measure resistance of the fuse, microswitches, and thermostats. Replace any failed components (refer to the wiring diagram).
9. If the input voltage at the high-voltage transformer primary input wires is close to the rating voltage 120 +/-15 VAC, unplug microwave oven or disconnect power.
 - Check for loose terminals (refer to the wiring diagram). Check all of the terminals on the main route from the power supply to the high-voltage transformer.
 - Check for loose or failed connectors on the ACU (P1, P2, P4). If these check out OK, plug in microwave oven or reconnect power.
 - Check for ACU failure. Refer to “ACU Pin Voltage Matrix.”
10. Check the power supply components. Refer to the “Component Tests” section.
 - High-voltage transformer
 - High-voltage capacitor
 - High-voltage diode

FOR SERVICE TECHNICIAN'S USE ONLY

11. If the power supply components check out OK, check the connection between the magnetron and the high-voltage transformer.
12. If all of the components check out OK, replace the magnetron.
13. Reconnect the high-voltage transformer primary windings.

ACU PIN VOLTAGE MATRIX

Check for proper voltage by completing the following steps:

1. Unplug microwave oven or disconnect power.
2. Connect voltage measurement equipment to the terminals listed below. (P1-3 and P2-3 are neutral.)
3. Plug in microwave oven or reconnect power, and confirm voltage reading.
4. Unplug microwave oven or disconnect power.

NOTE: For 50 V and over, the tolerance is +/-15 V. For 0 V, the tolerance is +/-3 V.

Abbreviations	CL - Cavity Light
HL - Hood Light	N - Neutral
FC - Forced Convection	HF - Hood Fan
L - Line Voltage	TT - Turntable Motor
NFS - Neutral for Switch	

NOTE: When checking voltage readings on ACU, connect the grounding test lead of voltmeter to ACU neutral wire. Use the positive test lead to probe connectors designated below.

Pin Name	Wire Color	MW Oven Plugged In—Sitting Idle—ACV Readings																		MW Oven Running — ACV Readings	
		Power On, Door Closed	Power On, Door Open	Hood Fan Motor — 1	Hood Fan Motor — 1 Door Open	Hood Fan Motor — 2	Hood Fan Motor — 2, Door Open	Hood Fan Motor — 3	Hood Fan Motor — 3, Door Open	Hood Fan Motor — 4	Hood Fan Motor — 4, Door Open	Hood Fan Motor — 5	Hood Fan Motor — 5, Door Open	Hood Fan Motor — 6	Hood Fan Motor — 6, Door Open	Hood Light — High	Hood Light — High, Door Open	Hood Light — Low	Hood Light — Low, Door Open		MW Oven Start
P1-1 (L)	Brown	120	120	120	120	120	120	120	120	120	120	120	120	120	120	120	120	120	120	120	120
P1-3 (N)	White	0	0	0	0	0	0	0	0	0	0	0	0	0	0	0	0	0	0	0	6
P2-1 (NFS)	White	0	120	0	120	0	120	0	120	0	120	120	120	120	120	0	120	0	120	0	6.3
P2-2 (Door)	Orange	0	120	0	120	0	120	0	120	0	120	120	120	120	120	0	120	0	120	0	50
P2-3 (N)	Brown/ Blue	0	0	0	0	0	0	0	0	0	0	0	0	0	0	0	0	0	0	0	6
P4-1 (FC-V)	Blue	0	0	0	0	0	0	0	0	0	0	0	0	0	0	0	0	0	0	0	0
P4-2 (TT)	Red	0	120	0	120	0	120	0	120	0	120	120	120	120	120	0	120	0	120	0	120
P4-3 (HF)	Green	0	120	0	120	0	120	0	120	0	120	120	120	120	120	0	120	0	120	0	120
P4-4 (CL)	Yellow	0	0	0	0	0	0	0	0	0	0	0	0	0	0	0	120	120	68	68	0
P4-5 (HF)	Black	0	0	120	120	85	85	80	80	74	74	67	67	61	61	0	0	0	0	0	0
P4-6 (HF-R)	Gray	0	0	120	120	85	85	80	80	74	74	67	67	80	80	0	0	0	0	0	0

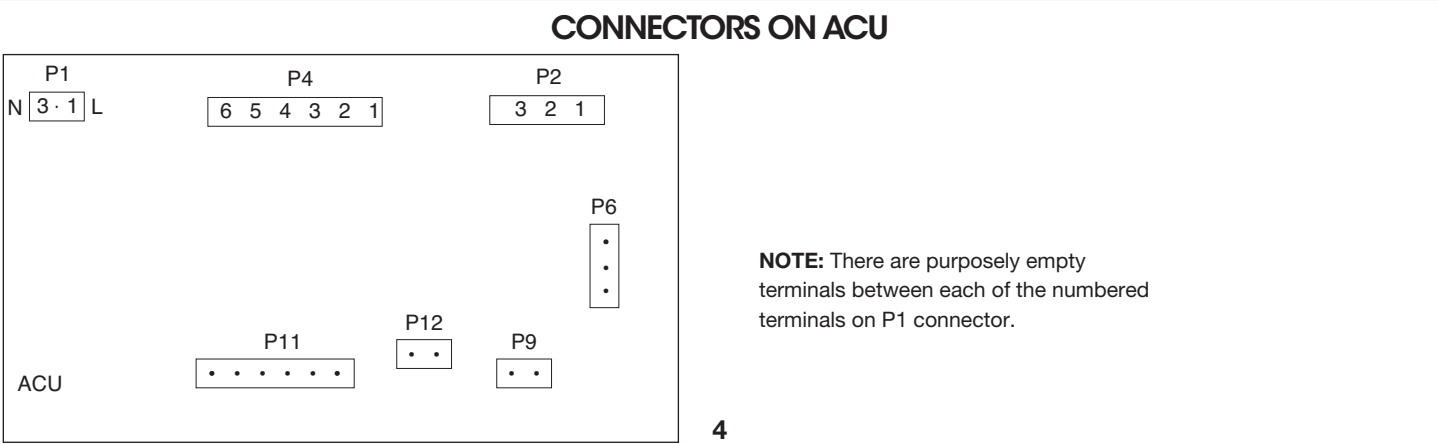

FOR SERVICE TECHNICIAN'S USE ONLY

TOUCH PANEL

Touch Panel and ACU Test

The microwave hood combination is provided with a self-diagnostic routine that can be accessed through the touch keypad.

To initiate this routine:

1. Plug in microwave oven or reconnect power and press the Cancel keypad to standby ("").
2. Close door, then press CANCEL - CANCEL - START within 3 seconds. All display segments will be lit to indicate the Test mode has been entered. In the upper left corner of the display, either the condition of the ACU will be displayed ("GOOD") or the most recent error code.

Key Tables for Test Mode

Key Name	Function	Display	Buzzer
Start	-Display UI SW, ACU PCB SW, Touch SW, EE PROM data Version and Gee version	Ul:xx.xx.xx, ACU:xx.xx.xx, TH:xx.xx.xx, EE:xx.xx.xx, Gee:xx.xx.xx (alternating)	Yes
Light or	-	key 30	1 beep
Vent Fan or	-	key 28	1 beep
Steam Clean	-	key 14	1 beep
Popcorn or AccuPop	-	POPCORN Testing, POPCORN Pass, or POPCORN Fail*	1 beep
Defrost	-	key 05	1 beep
Soften/Melt	-	key 09	1 beep
Steam/Simmer	-	key 12	1 beep
Air Fry	-	key 19	1 beep
Grill	Grill Heater Check	Grill	1 beep
Keep Warm	NTC ambient temperature check	0000-0120	1 beep
Cook/Reheat	Humidity Sensor check	7000-9999	1 beep
Time/Power	Failure history check	If no error history: GOOD If error history: FxEx YY FxEx YY...	1 beep
	-	key 45	1 beep
	-	key 46	1 beep

* Knock on microwave oven door 12-24 times, and then the result (Pass or Fail) will be displayed.

Key Name	Function	Display	Buzzer
Turntable	-	key 29	1 beep
Select	-	key 27	1 beep
Timer Set/Off	Erase Service Error Records	GOOD	1 beep
Setup or Settings	Error history check	If no error history: GOOD If error history: FxEx FxEx...	1 beep
Convect Bake or Bake	-	0000-0260	1 beep
Convect Roast or Roast	-	key 53	1 beep
1	Cavity Light On	Cavity Lamp	1 beep
2	Cavity Light and Turntable On	Light and Turntable	1 beep
3	TT, CL, MW Relays 4913 and 4903 (1200 W) On	MW Turbo On	1 beep
4	-	key 34	1 beep
5	-	key 35	1 beep
6	Hood Light Relay 4910 On	Hood Light High	1 beep
7	Hood Light Relay 4909 On	Hood Light Low	1 beep
8	Vent Fan Relay 4911 On (High Speed)	Hood Fan Highest	1 beep
9	Vent Fan ON Relay 4911 OFF (Low Speed)	Hood Fan Lowest	1 beep
0	TT, CL, MW Relays 4913 and 4903 (1050 W) On	MW	1 beep
Cancel	Exit Test Mode		1 beep

FOR SERVICE TECHNICIAN'S USE ONLY

PARTS LAYOUT (NOT TO SCALE)

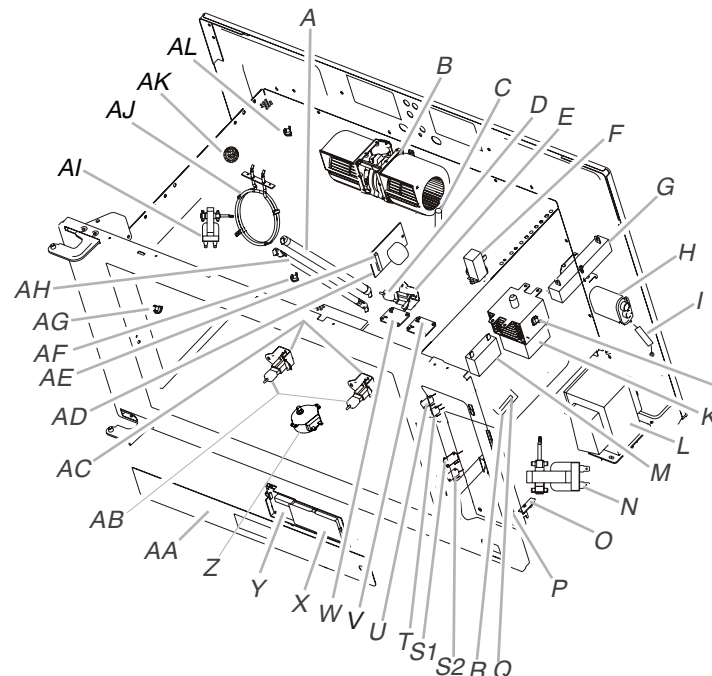

- A. Quartz grill heater
- B. Hood fan motor assembly
- C. FC thermistor
- D. Cavity light
- E. Cavity light holder
- F. FC thermoactuator
- G. Power resistor
- H. H.V. capacitor
- I. H.V. diode
- J. Magnetron thermostat—opens at 293°F (145°C), closes at 221°F (105°C)
- K. Magnetron
- L. H.V. transformer
- M. Motor capacitor
- N. Cooling fan motor
- O. HF NTC thermistor
- P. ACU
- Q. Turbo fuse (20 amp)
- R. Turbo fuse holder
- S1. Secondary interlock switch
- T. Monitor interlock switch
- U. Primary interlock switch
- V. POPCORN ACU

POWER OUTPUT MEASUREMENT

The power output of the magnetron can be measured using the following "Voltage Measurement at Power Source" and "Output Test." Before you perform the test:

- Make sure that the oven cavity is cool and clean.
- Check the line voltage at the wall outlet while microwave oven is operating. See "Voltage Measurement at Power Source."

Tools Needed

- 2-cup measuring cup
- Thermometer
- Voltmeter/ohmmeter

Voltage Measurement at Power Source

1. Fill the measuring cup with 2 cups (500 mL) of tap water.
2. Place in the center of the microwave oven cavity.
3. Operate the microwave oven on high power for 1 minute.
4. While the microwave oven is operating, measure the line voltage at the power source. See "Measure Voltage" illustration.
5. Verify the voltage is constant during microwave oven operation. If voltage drops below 108 V, contact a qualified electrician to check your electrical supply.
6. Make note of the voltage while the microwave oven is running, and proceed to the output test.

Output Test

1. Fill the measuring cup with 2 cups (500 mL) of 70°F (21°C) tap water.
2. Stir the water with the thermometer to ensure uniform temperature. Add warm or cool water to bring the water to the correct temperature.
3. Place the measuring cup in the center of the microwave oven cavity.
4. Operate the microwave oven on high power for 1 minute.
5. Remove the measuring cup and stir the water with the thermometer for about 20 seconds.
6. Record the temperature of the water.
7. Refer to the model serial tag on the microwave oven to acquire wattage output rating of the microwave oven.

Water Temperature for Line Voltage and Wattage Rating

Voltage	700 W	1000 W	1200 W
120 V	96°F to 102°F (36°C to 39°C)	110°F to 116°F (43°C to 47°C)	124°F to 130°F (51°C to 54°C)
108 V	91°F to 97°F (33°C to 36°C)	101°F to 107°F (38°C to 42°C)	111°F to 117°F (44°C to 47°C)

FOR SERVICE TECHNICIAN'S USE ONLY

COMPONENT TESTS

IMPORTANT:

- Unplug microwave oven or disconnect power.
- Discharge the high-voltage capacitor and remove the lead wires from the primary winding of the high-voltage transformer before conducting any of the following tests.
- Remove the lead wires from the related component before conducting any of the following tests.
- All operational checks using microwave energy must be done with the microwave oven loaded with a minimum of 8 oz (250 mL) of water in a microwave-safe container.

Components Test/Results

H.V. Transformer

1. Unplug microwave oven or disconnect power.
2. Remove wire leads.
3. Measure resistance:
 - Primary winding: Less than 0.5 ohm (approximate)
 - Secondary winding: 120 ohms (approximate)
 - Filament winding: 0 ohms
 - Primary winding to grounding: Normal: Infinite
 - Filament winding to grounding: Normal: Infinite

Magnetron

1. Unplug microwave oven or disconnect power.
2. Remove wire leads.
3. Measure resistance:
 - Filament terminal: Normal: Less than 1 ohm
 - Filament to chassis: Normal: Infinite

H.V. Capacitor

1. Unplug microwave oven or disconnect power.
2. Remove wire leads.
3. Measure resistance:
 - Terminal to terminal: Normal: Momentarily indicates several ohms and then gradually returns to infinite.
 - Terminal to case: Normal: Infinite

Motor Capacitor

1. Unplug microwave oven or disconnect power.
2. Remove wire leads.
3. Measure motor capacitor:
 - Normal: Momentarily 0 ohms, then goes to infinite

Cooling Fan Motor

1. Unplug microwave oven or disconnect power.
2. Remove wire leads.
3. Measure resistance:
 - Normal: 40 to 60 ohms (approximate)

H.V. Diode

- NOTE:** Some inexpensive meters may indicate infinite resistance in both directions.
1. Unplug microwave oven or disconnect power.
 2. Measure resistance:
 - Forward: Normal: Continuity
 - Reverse: Normal: Infinite

FC Thermistor

1. Unplug microwave oven or disconnect power.
2. Remove wire leads.
3. Measure resistance:
 - Normal: 17 k +/-20% ohm at 77°F (25°C)

Components Test/Results

Turntable Motor

1. Unplug microwave oven or disconnect power.
2. Remove wire leads.
3. Measure resistance:
 - Normal: 2.4 k to 3.2 k ohms (approximate)

FC Motor

1. Unplug microwave oven or disconnect power.
2. Remove wire leads.
3. Measure resistance:
 - Normal: 23 to 25 ohms

Humidity Sensor

1. Unplug microwave oven or disconnect power.
2. Remove the 3-pin connector from the electronic control (P6).
3. **NOTE:** Do not remove the attached resistor which is used for internal resistance calibration.
4. Measure resistance across pins 1 and 3 and across pins 2 and 3:
 - Normal: 2.8 k ohms (approximate) at 77°F (28°C) +/-18°F (-10°C)

Hood Exhaust Fan Motor

1. Unplug microwave oven or disconnect power.
2. Remove wire leads.
3. Measure resistance:
 - High Speed—Normal: Red (RD) and Blue (BU) wires: 70 to 100 ohms (approximate); Blue (BU) and Black (BK) wires: 30 to 60 ohms (approximate)
 - Low Speed—Normal: Red (RD) and Blue (BU) wires: 70 to 100 ohms (approximate); Blue (BU) and White (WH) wires: 50 to 80 ohms (approximate)

HF NTC Thermistor

1. If "NTC SHORT, CALL FOR SERVICE" or "NTC OPEN, CALL FOR SERVICE" scrolls on display, unplug microwave oven or disconnect power.
2. Measure resistance:
 - Normal: 10 k ohms +/-5% at 77°F (25°C)

FC Thermistor

1. Unplug microwave oven or disconnect power.
2. Remove wire leads.
3. Measure resistance:
 - Normal: 17 k +/-20% ohm at 77°F (25°C)

FOR SERVICE TECHNICIAN'S USE ONLY

Components Test/Results

- #### FC Ring Heater
1. Unplug microwave oven or disconnect power.
 2. Remove wire leads.
 3. Measure resistance:
 - Normal: 9 +/-3 ohms

Motor Capacitor

1. Unplug microwave oven or disconnect power.
2. Remove wire leads.
3. Measure resistance:
 - Normal: 1.2 k +/-0.5 k ohms

Power Resistor

1. Unplug microwave oven or disconnect power.
2. Remove wire leads.
3. Measure resistance:
 - Normal: 20 ohms/25 W

AC Line Filter Board

1. Unplug microwave oven or disconnect power.
2. Remove wire leads.
3. Measure resistance:
 - Normal: L-IN to L-OUT (coil): Less than 1 ohm; N-IN to N-OUT (coil): Less than 1 ohm

Components Test/Results

- #### Thermostats
- NOTE:** Refer to "Parts Layout" for opening and closing temperatures
- #### FC/Magnetron/Cavity Thermostat
1. Unplug microwave oven or disconnect power.
 2. Remove wire leads.
 3. Measure resistance:
 - Normal: Continuity

Halogen Grill Element

1. Unplug microwave oven or disconnect power.
2. Remove wire leads.
3. Measure continuity (ohmmeter scale: Rx1):
 - Normal: 2 +/-1 ohms

Quartz Grill Heater

1. Unplug microwave oven or disconnect power.
2. Remove wire leads.
3. Measure resistance:
 - Normal: 29 +/-5 ohms

SCHEMATIC DIAGRAM

